

CCSD Wireless Directions: Kindle

The following are directions for connecting your **PERSONAL** Kindle device to the CCSD Secured Wireless Network. You must complete **all three sections** and **follow all steps** for the Internet to work properly: Connect to Wireless, OnBoarding Verification, and Certificate Download.

Connect to Wireless

1. Go to your WiFi settings and select the **CCSDWireless** network.
2. You will need to enter the **Password** provided by your local school's Library Media Specialist, Lab Manager, School Administrator, or TTIS. Press **Connect**.
3. Return to the device Home screen by clicking the **Home button** (center circle).
4. Open a web browser (i.e. Silk, Opera) and navigate to login.cobbk12.org.

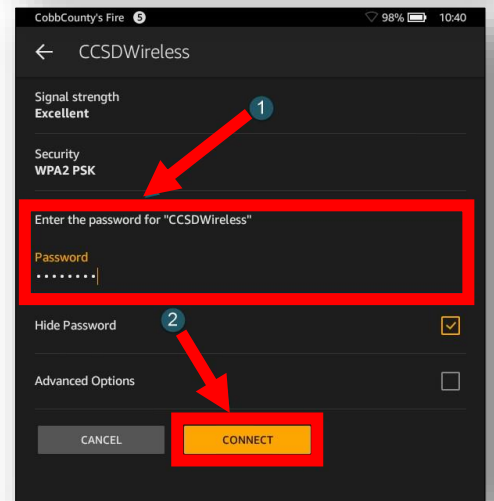
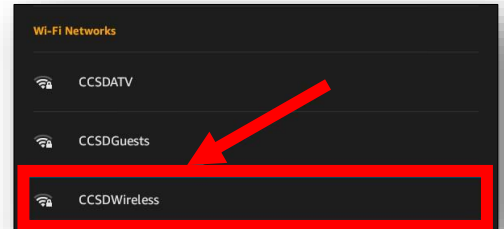

OnBoarding Verification

5. Sign in to CCSDWireless using your **badge ID** (for staff) or **lunch number** (for students) and **Network Password**.
Note: Network password is the same password used to access any school computer. Remember to check the Acceptable Use Policy after reading the terms.

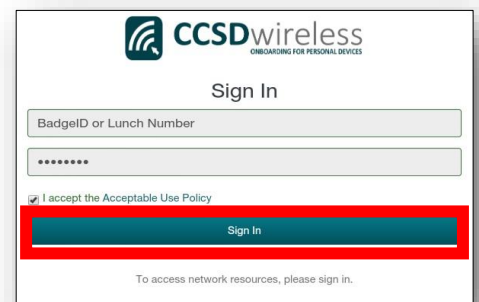

Certificate Download

- You will be redirected to the SSL Certificate Page. Click the **gold key** to install the SSL Certificate.

Note: If you are not redirected to the SSL Page, open a web browser, and go to cert.cobbk12.org.



- Once the SSL Certificate has finishing downloading, click **Open** to begin installation.



- When prompted for a Certificate Name, enter **ccsdssl**. Click **OK**.

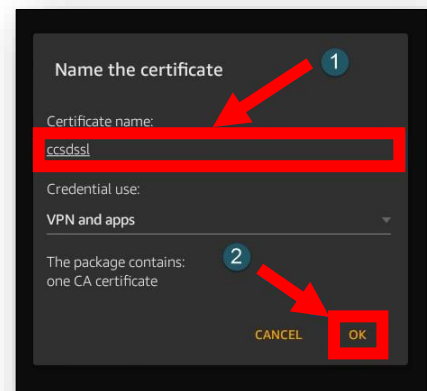

- Your device may require that you confirm your PIN (unlock code) before saving the SSL Certificate. If prompted, enter the **PIN**, then click **Continue**.

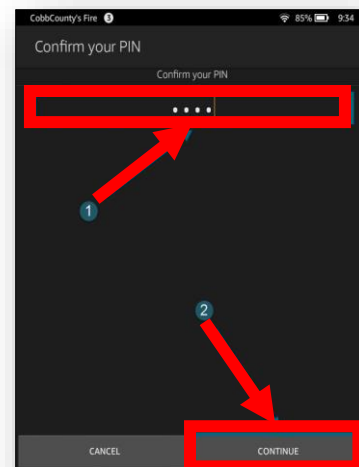

- Navigate to a secure HTTPS site like www.yahoo.com, www.google.com or www.bing.com. Verify that the page displays properly.