

Student Dashboard (Custom View)

When you log in to CTLS Student, you will see the Student Dashboard.

In Custom view, the Dashboard shows these widgets:

- My Shortcuts**
- My Announcements**
- My Work**
- My Available Assessments**
- My Upcoming Events**

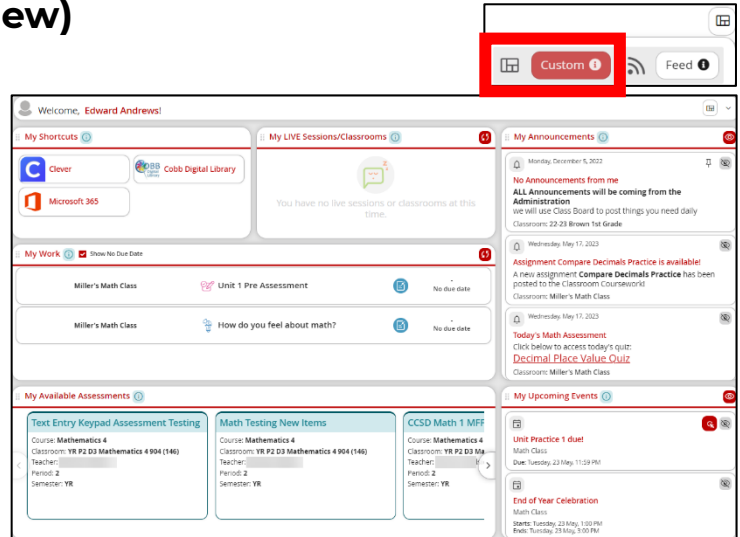

Student Dashboard (Feed View)

On the Dashboard, you can switch to Feed View to see a running list of all Announcements and Board Posts created by your teachers.

Other widgets in Feed view are **My Upcoming Events** and **My Shortcuts**.

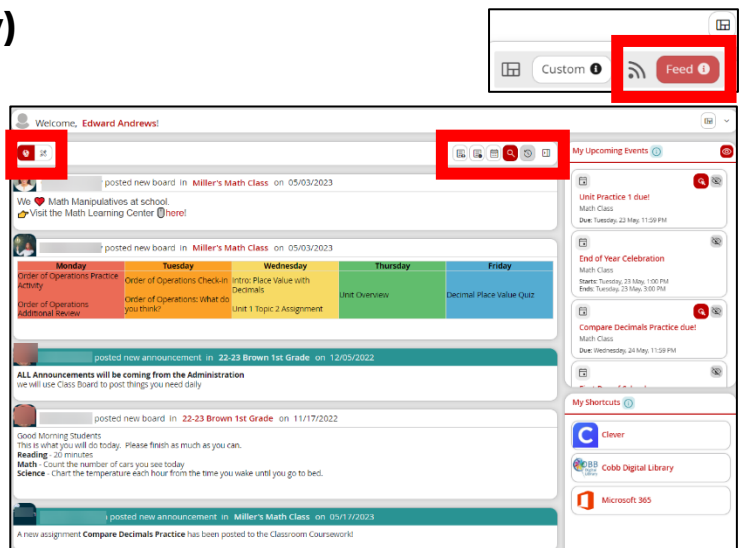

Additional filters in Feed View include:



All Posts



My Work



Filter by Class



Filter by Type



Filter by Date



Search



Reset All Filters

Accessibility Tools and Student Profile

Locate the following features and accessibility tools in the top right corner.



Check for Updates



Line Reader



Color Contrast



Read Aloud



Notification Bell



Student Profile

Select a Class

In the top left corner of your Dashboard, click **Select a class** to navigate directly into one of your classes. This option is also available on the left-hand navigation.

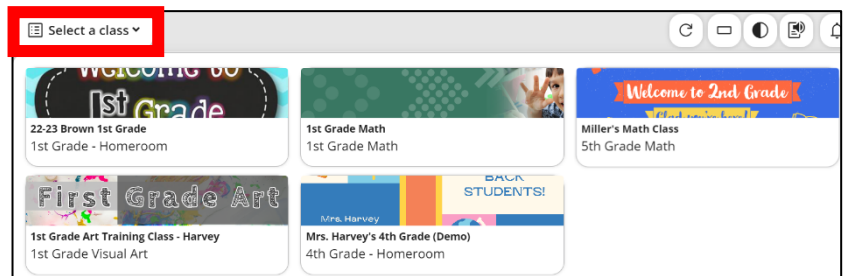

Left-Hand Navigation

Navigate to other areas of CTLS Student using the left-hand navigation.

My Dashboard – From anywhere within CTLS Student, click here to come back to your Dashboard.

My Calendar – Click to view assignments and events on a calendar.

My Classes – Click to view tiles for each class to which you are rostered.

My Grades – Click to view all Assignments, Assessments, and Discussion Posts.

My Assessments – Click to view all active Assessments.

My Chats – Click to access chats with teachers and group chats started by teachers.

