

# COBB COUNTY SCHOOL DISTRICT

## NEW STUDENT LAPTOP LOGIN STEPS

**STEP 1** Connect the charging cord to the laptop and plug into power. Power on the laptop by pressing the power button. It will take a moment to load.



**STEP 2** Select the default US keyboard layout and click **Yes**, then choose **Skip** on the next screen prompting you to add a second keyboard layout.

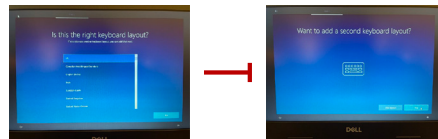

**STEP 3** Connect to your home wifi network by selecting it from the list and entering the password. Then click **Next** to join. Once connected, select Next again and the computer will automatically reboot.

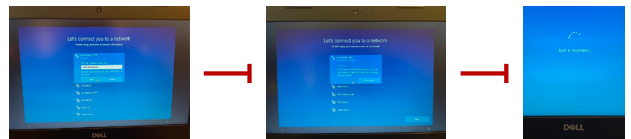

**STEP 4** Enter your O365 email address and click **Next**. You will be directed to another screen and prompted to re-enter your email address as well as password. Then click **Sign in**.

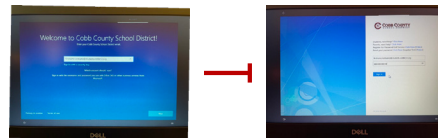

**STEP 5** Windows 10 will begin to load. You are logged in once you see the Cobb County desktop.

